

Product Data Sheet

SUPER ROAD FLARE & KIT

No. **41165** - 04/23



PRODUCT NUMBER:

1164 - SAFETY YELLOW SUPER ROAD FLARE AMBER LEDs
1165 - SAFETY ORANGE SUPER ROAD FLARE RED LEDs

1167 - SAFETY YELLOW SUPER ROAD FLARE KIT AMBER LEDs
1168 - SAFETY ORANGE SUPER ROAD FLARE KIT RED LEDs

US Patent #D654,387S and 8,550,653B2

I. GENERAL DESCRIPTION

Features: The Aervoe Super Road Flare is an extremely durable, rechargeable 24-LED flare that is a safe alternative to incendiary flares. This flare is unique with two rows of lights that increase visibility. The flare is made of crushproof polycarbonate plastic with an impact resistant rubber housing. It features 7 different flash patterns, including a reverse rotate pattern utilizing the two rows of LEDs, with visible light range of 1 to 2 miles. The housing is waterproof and will float. Also includes a strong magnet to attach it to any magnetic metal surface. This unit has an intrinsically safe design with a rubber-tight seal, but is not certified as such.

The single pack #1164 and #1165 models come with a magnetic connector hub, USB charging cable, and a storage bag. 120V AC and 12V DC adapters are available from any general merchandise retailer.

The kits come with a total of 4 Super Road Flares, a storage case that also operates as the charging case, a 120V wall charger, and a 12V car charger.

Benefits: These rechargeable Super Flares replace toxic incendiary flares. There is no smoke, flame or ash created and is a convenient way to signal detours or road hazards. It may be attached to a magnetic metal surface, including cars, trucks, and signs, using the heavy duty N35 magnet. The rechargeable design means there are no batteries to replace. It may be charged from a wall outlet or

a car power outlet (kits only). The 4-pack Kit is an ideal size for emergency responders.

Uses: May be used in any weather condition. Ideal for road safety identification by emergency responders, or for personal vehicle operators as an emergency signaling device. May also be used on construction sites and in marine applications for boater emergency safety. Place on the road, any magnetic surface, in the water, and much more.

Warnings: Read operating instructions thoroughly prior to use. If used in wet environments, thoroughly dry flares prior to charging or storage to eliminate corrosion on charging contacts. Only use the provided CE and C/UL certified AC and DC chargers supplied with this product or an equivalent replacement with the same inputs and outputs as listed in the specification section. Failure to use the specified charger could be hazardous, cause damage to the product, and voids the warranty. Monitor during charging and disconnect when charging has finished.

DOT & Traffic Safety Compliance:

1. U.S. DOT (FMCSA) 49 CFR § 392.25 & 393.95(g) Prohibits the carrying of any flame-producing flare on any Commercial Motor Vehicle (CMV) transporting explosives; any cargo of flammable liquid or flammable compressed gas, whether loaded or empty; or any CMV using compressed gas as a motor fuel.
2. MUTCD Type A (flashing) and Type C (solid on)
3. NFPA 1901 Standards for Traffic Safety, Section 6.7.3 Miscellaneous Equipment.

Packaging:

Each clamshell:	2 lbs. (0.91 kg)	0.23 CF (0.006 CM)	9.75" L x 13.5" W x 3" H
Case (4/case):	8 lbs. (3.63 kg)	0.72 CF (0.02 CM)	10" L x 14.5" W x 8.6" H
Each kit:	4 lbs. (1.81 kg)	0.48 CF (0.014 CM)	16.75" L x 12.375" W x 4" H
Case (2/case):	10 lbs. (4.54 kg)	1.09 CF (0.03 CM)	17.3" L x 12.75" W x 8.5" H



Aervoe Industries, Inc.
P.O. Box 485, Gardnerville, NV 89410



(775) 783-3100 Phone • (775) 782-5687 Fax • (800) 227-0196 Customer Service
www.aervoe.com • mailbox@aervoe.com

II. DIAGRAM

Kit

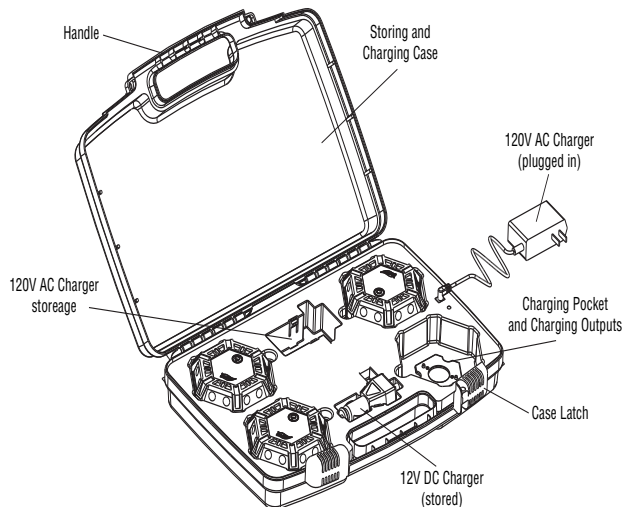

Single Flare

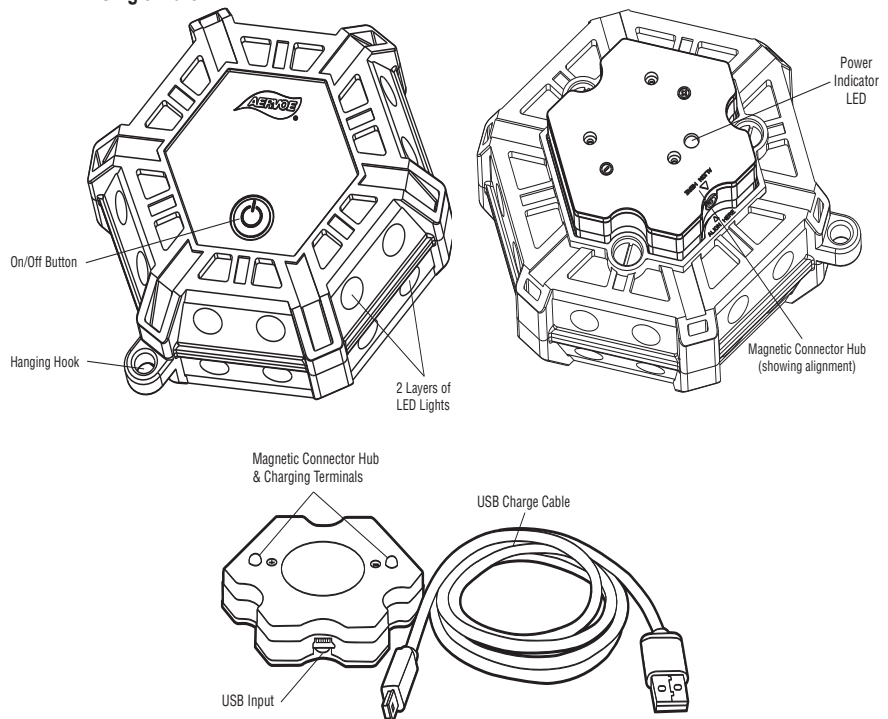

III. SPECIFICATIONS

Internal Rechargeable Battery.....	Lithium Polymer 1200 mAh ~ 3.7V
#1164/5:	
120V AC/DC Charger: (FCC, CE & C/UL Listed)	Input: 100-240V AC, 50-60Hz
(Not Included)	Output: 5V, 1200 mAh
12V DC Charger: (CE)	Input: 12V DC
(Not Included)	Output: 5V DC, 2.1A
#1167/8:	
120V AC/DC Charger: (FCC, CE & C/UL Listed)	Input: 100-240V AC, 50-60Hz 0.5A
	Output: 6.5V, 1200 mAh
12V DC Charger: (CE)	Input: 12V DC
	Output: 6.5V, 1200 mAh
	Fuse: 250V DC 2 amp 1/4 x 1 1/4 glass fuse
Charging Times:	1-2 flares = 4-6 hours
	All 4 flares = 6-8 hours
Temperature Range.....	14°F to 122°F (-10°C - 50°C)
Weight	1164/5: 8 oz.
	1167/8: 3.25 lbs.
Dimensions.....	1164/5: 5.25" L x 4.25" W x 1.875" H
	1167/8: 16.75" L x 4" W x 12.375" H

FLASH PATTERN	TYPICAL RUN TIME	FLASH PATTERN	TYPICAL RUN TIME
#1 - REVERSE ROTATE	8 HOURS	#5 - S.O.S. RESCUE (MORSE CODE)	8 HOURS
#2 - QUAD FLASH	10 HOURS	#6 - STEADY ON	6 HOURS
#3 - ALTERNATING BLINK	8 HOURS	#7 - 4-LED MARKER LIGHT	9 HOURS
#4 - QUICK FLASH	8 HOURS		

IV. SHIPPING, STORAGE AND HEALTH

UN number	3481
Proper Shipping Description	Lithium Ion batteries contained in equipment
Hazard Class	9
Packing Group	N/A
Limited Quantity	N/A
Warehouse storage level number	N/A
Storage temperature.....	70°F
Shelf life	1 to 2 years
HMIS ratings	
Health.....	N/A
Fire.....	N/A
Reactivity	N/A

IV. MISCELLANEOUS

Replacements for the Kit may be purchased using P/N #1164, or 1165 for the flares from your local retailer or www.aervoe.com.

V. WARRANTY

1-year performance warranty on all products from date of purchase. Report to home office or local Aervoe representative for examination. Because Seller cannot control Buyer's handling or use of product, Seller makes no warranty expressed or implied when not used or stored in accordance with directions. Seller shall not be liable for cost of labor, incidental or consequential damages, and this warranty is limited to replacement of product or credit of purchase.